

Somfy Connect™ LTI

Part #1870210



Overview:

The Somfy Connect™ LTI expands the capabilities of Somfy systems providing a centralized logic center and communication bridge. Connect allows Somfy Digital Network (SDN) and Radio Technology Somfy (RTS) systems to interact with third party systems allowing the shading system to become part of a truly integrated part of commercial and residential automation systems. The Somfy Connect is equipped with a real-time hardware clock for scheduling shading events. The internal clock keeps time without the need for accessing an external time server and though power loss, ensuring continuous reliable operation. The Connect has Lutron®'s Integration protocol built in allowing Lutron®'s handheld and in-wall controls from RadioRA® 2, HomeWorks® QS, Grafik Eye® QS, and Quantum® systems to operate Somfy motorized applications.



Somfy Connect™ Range Overview:

The Somfy Connect™ product line expands the functionality of Somfy motorization systems, providing a communication gateway for Radio Technology Somfy (RTS) and Somfy Digital Network (SDN) systems to easily integrate with third party control systems in both residential and commercial jobsites.

Features Summary:

- Centralized logic center and communication bridge
- Hardware realtime clock for scheduled events
 - Astronomic events
 - Repeatable schedules
- Support for RadioRA® 2, HomeWorks® QS, Quantum®, and GRAFIK Eye® QS systems
 - Able to interpret:
 - Button press
 - Button release
 - Button Hold
 - Toggle
 - Group Raise/Lower
- 300 Programmable Lutron Home Control and communication maps
- 198 programmable timed events

Technical Specifications:

- Input: 9-24v DC
- Power Consumption: 100ma
- Material: ABS
- Dimensions: 6" x 3.5" x 1.5"
- Operating Temperature Range: ambient
- Shipping Weight: 1 Lb.

Optional Accessories:

- USB to RS485 Adapter 9015260
- URTSI 1810872
- Power Supply Bus & Sensor 1822440

What's in the Box:

- Somfy Connect™ LTI
- DB9 cable (6'; male to female; straight through) RX

Connections and Indicators:

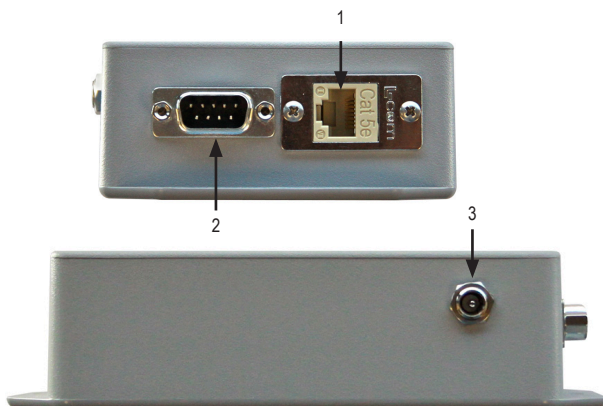

| ELEMENT | FUNCTION |
|--------------------|---|
| 1 SDN BUS | RS485 - Connect to SDN system or URTSI |
| 2 Integration Port | RS232 - Connect to Lutron Intergration port |
| 3 Power | 3.5mm Barrel connector (female) |



Cable Pinouts:

RJ 45 Pinout

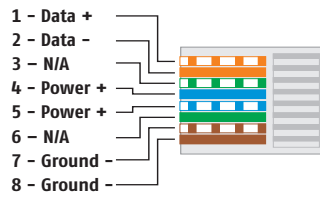

DB9 pinout

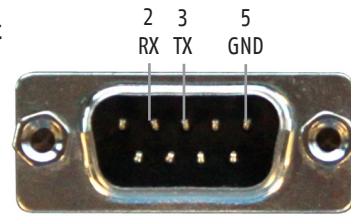

Dimensions:

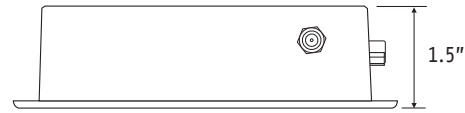
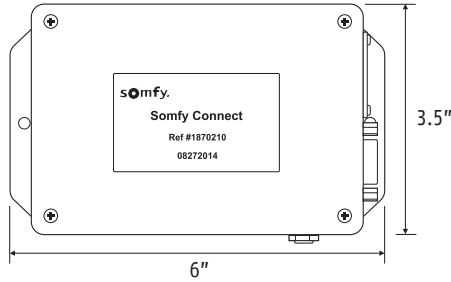

Wiring Best Practices:

SDN

The Somfy Connect™ LTI joins a SDN network through a single connection which provides communication and power. Wiring from a SDN Data Hub to the Connect should not be more than 30Ft.

Somfy Connect SDN with Lutron RadioRa®

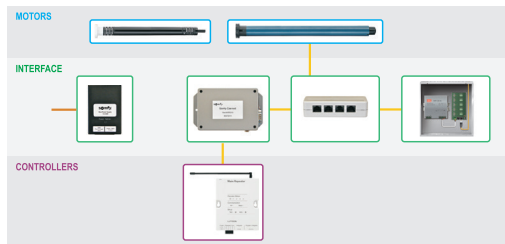

RTS

The Somfy Connect™ LTI L RTS utilizes a URTSI to transmit RTS commands. Connect to the URTSI using a single wire connecting the SDN port of the connect and the RS-485 port of the URTSI. Additional range and channels can be added by introducing more URTSI into the system and interconnecting them through the RS485 output.

Somfy Connect™ LTI RTS (URTSI) with Lutron

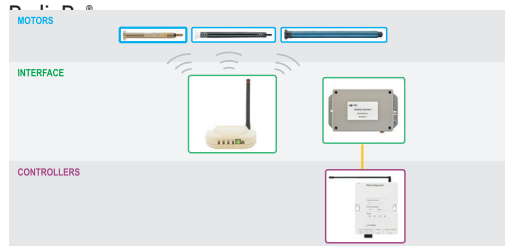

The DB9 RS232 connection to connect to Lutron's Integration port, this connection must be under 50ft in length.

Wiring Connection Types

| Wireless | Third Party | Somfy Digital Network (SDN) |
|----------|-----------------|-----------------------------|
| RTS | RS232 - 50' max | SDN |
| WiFi | RS485 - 4K' max | SDN (data) |
| Z-Wave® | IR | SDN with motor power |
| ZigBee® | Ethernet | Sensor Bus |